

PARTITION TYPE GENERAL NOTES

1. WHERE STRUCTURAL SPECIFICATIONS OR DRAWINGS INDICATES HEAVIER GA. STUDS AND/OR CLOSER SPACING, STRUCTURAL SHALL GOVERN.
2. REFER ROOM FINISH SCHEDULE & ALL OTHER DRAWINGS FOR FINISHES, WHICH MAY NOT BE INDICATED ON THE PARTITION TYPE DETAILS.
3. ALL GYP. BD. IN RESTROOM, TOILET ROOMS & JANITOR CLOSETS SHALL BE WATER-RESISTANT GYP. BD. TO CEILING ABOVE.
4. ALL GYP. BD. IN SHOWER ROOMS SHALL BE WATER-RESISTANT GYP. BD. TO FULL HEIGHT OF WALL.
5. PARTITIONS SHALL EXTEND ABOVE CEILING TO HEIGHT INDICATED OR TO BOTTOM OF FLOOR/ROOF DECK, WHICHEVER COMES FIRST.
6. ALL PENETRATIONS IN FIRE RATED WALLS SHALL BE PROPERLY FIRE CAULKED AND FIRE-STOPPED AS REQ'D BY CODE.
7. ALL PENETRATIONS IN SMOKE PARTITIONS SHALL BE PROPERLY CAULKED/SEALED AS REQ'D BY CODE.
8. TOPS OF RATED WALLS SHALL BE FIRE CAULKED TO DECK ABOVE AND FILLED WITH MINERAL WOOL.

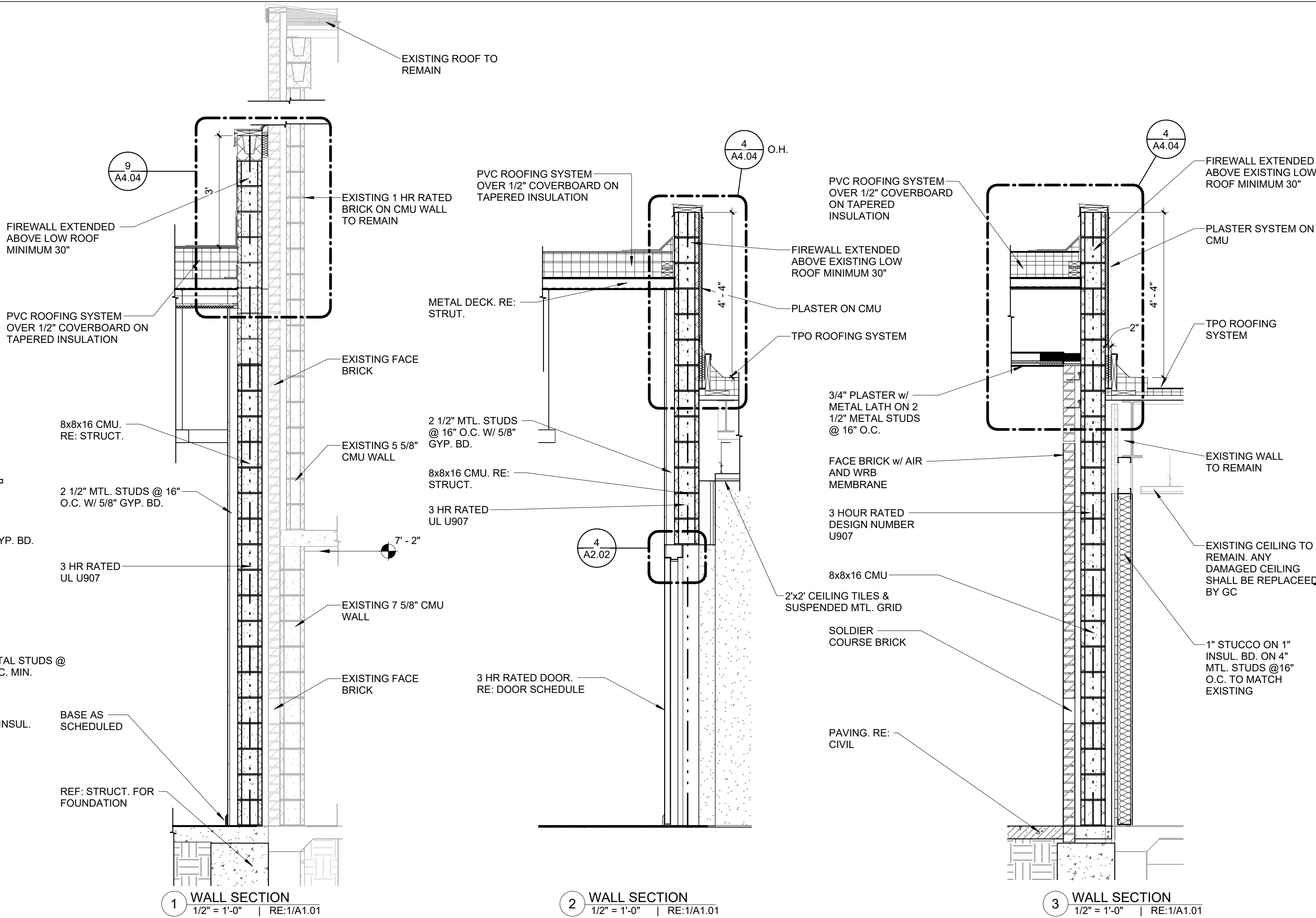

EXTERIOR WALL ASSEMBLY DETAILS

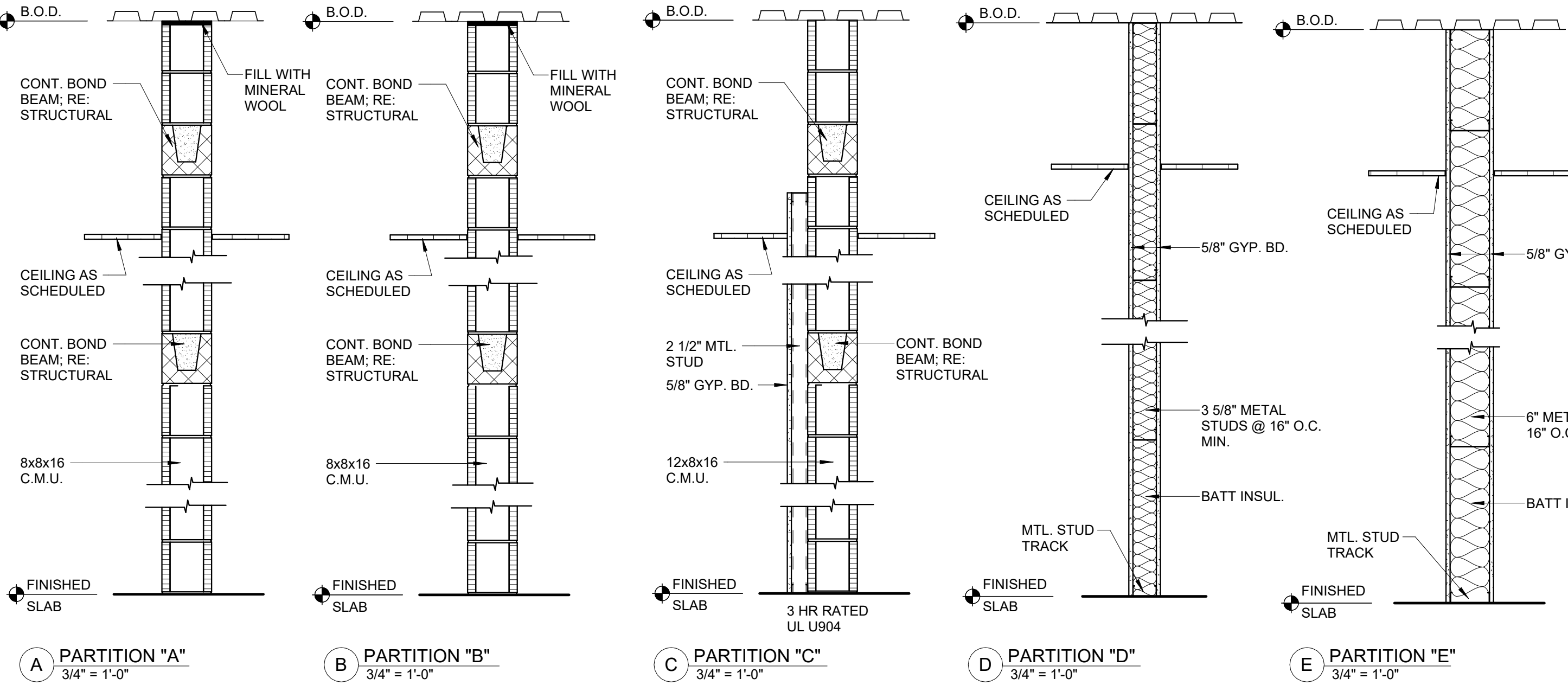
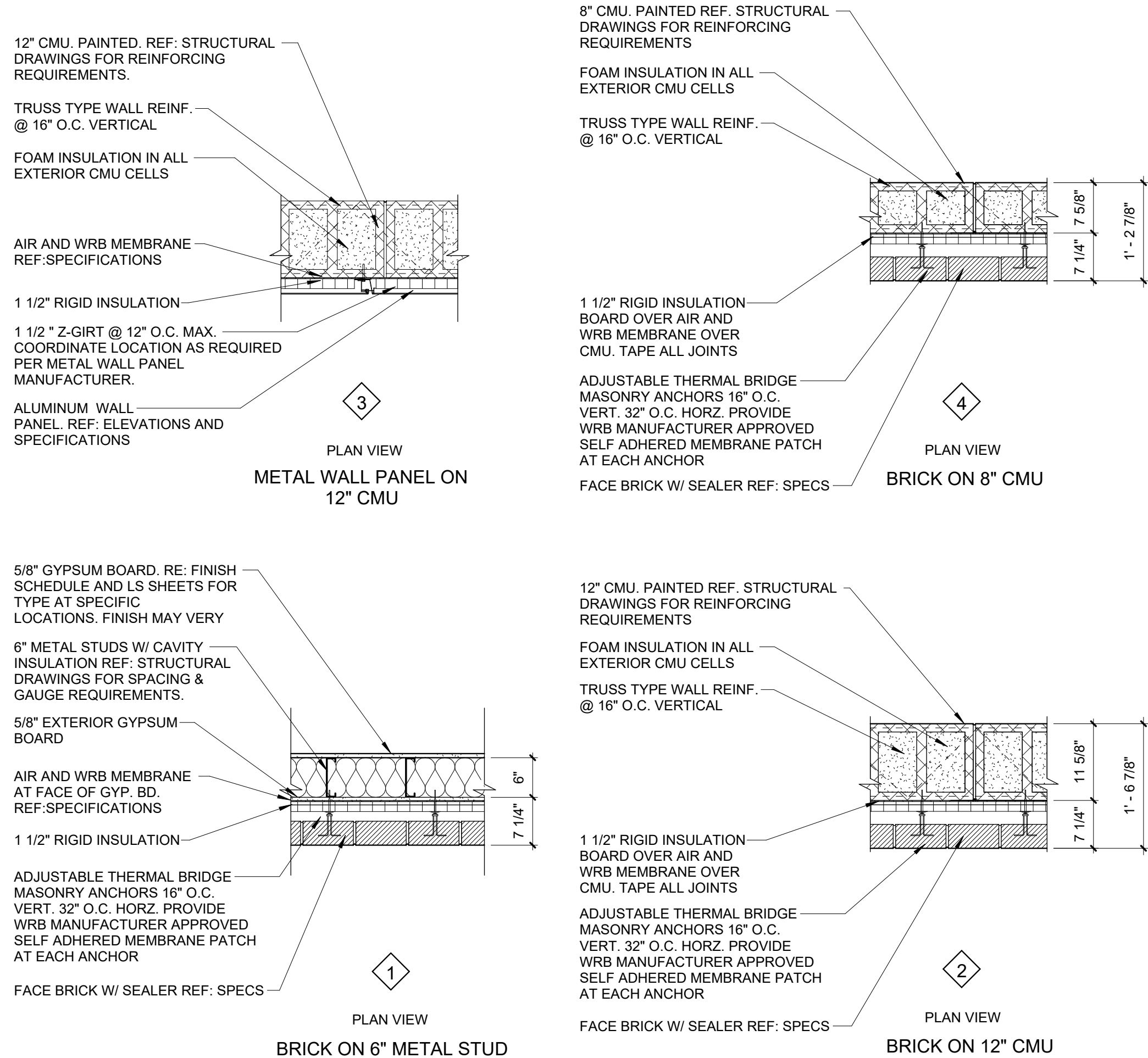

BXUV.U907 - Fire-resistance Ratings - ANSI/UL 263

Page 1 of 2

UL ONLINE CERTIFICATIONS DIRECTORY

Design No. U907
BXUV.U907
Fire-resistance Ratings - ANSI/UL 263

Print Bottom

Design/System/Construction/Assembly Usage Disclaimer

- Authorities Having Jurisdiction should be consulted in all cases as to the particular requirements covering the installation and use of UL Certified products, equipment, systems, devices, and materials.
- Authorities Having Jurisdiction should be consulted before construction.
- Fire resistance assemblies and products are developed by the design submitter and have been investigated by UL for compliance with applicable requirements. The published information cannot always address every construction nuance encountered in the field.
- When field issues arise, it is recommended the first contact for assistance be the technical service staff provided by the product manufacturer noted for the design. Users of fire resistance assemblies are advised to consult the general Guide Information for each product category and each group of assemblies. The Guide Information includes specifics concerning alternate materials and alternate methods of construction.
- Only products which bear UL's Mark are considered Certified.

BXUV - Fire Resistance Ratings - ANSI/UL 263

BXUV7 - Fire Resistance Ratings - CAN/ULC-S101 Certified for Canada

See General Information for Fire-resistance Ratings - ANSI/UL 263

See General Information for Fire Resistance Ratings - CAN/ULC-S101 Certified for Canada

Design No. U907

December 03, 2014

Nonbearing Wall Rating - 3 or 4 HR.

(See Item 1)

* Indicates such products shall bear the UL or cUL Certification Mark for jurisdictions employing the UL or cUL Certification (such as Canada), respectively.

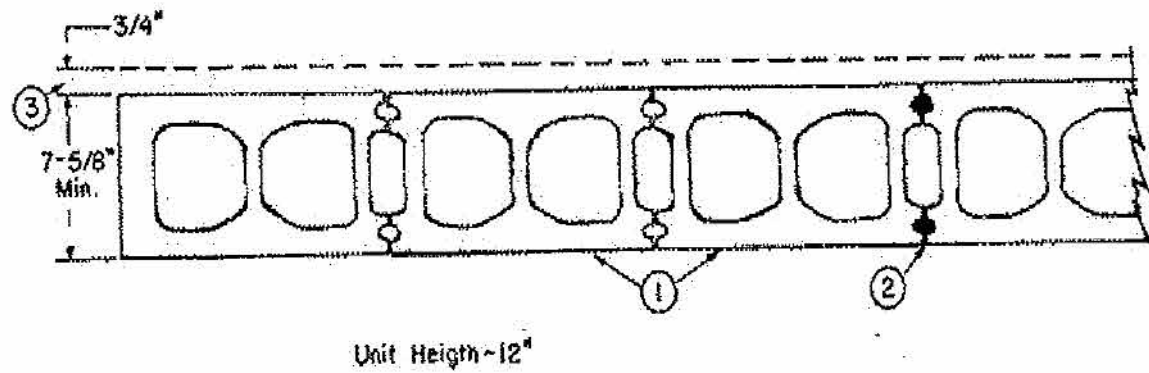

1. Concrete Blocks* - Various designs. Classification C-3 (3 hr) and B-4 (4 hr).

See Concrete Blocks category for list of eligible manufacturers.

2. Mortar - Blocks laid in full bed of mortar, nom. 3/8 in. thick, of not less than 2-1/4 and not more than 3-1/2 parts of clean sharp sand to one part Portland cement (proportioned by volume) and 15 percent hydrated lime (by cement volume). Vertical joints staggered.

http://database.ul.com/cgi-bin/XYV/template/LISEXT/1FRAME/showpage.html?name=... 01/27/2015

BXUV.U907 - Fire-resistance Ratings - ANSI/UL 263

Page 2 of 2

3. Portland Cement Stucco or Gypsum Plaster - Add 1/2 hr to classification if used. Attached to concrete blocks (Item 1).
4. Loose Masonry Fill - (Not shown) - If all core spaces are filled with loose dry expanded slag, expanded clay or shale (rotary kiln process), water repellent vermiculite masonry fill insulation, or silicone treated perlite loose fill insulation, Class C-3 (3 hr) concrete blocks will provide a 4 hr fire resistance rating.
5. Foamed Plastic* - (Optional-Not Shown) - 1-1/2 in. thick max, 4 ft wide sheathing attached to concrete blocks (Item 1) or interior wall surface.
- ATLAS ROOFING CORP - "EnergyShield Pro Wall Insulation" and "EnergyShield Pro 2 Wall Insulation."
- CARLISLE COATINGS & WATERPROOFING INC - Type R2+ Sheath
- HUNTER PANELS - Type Xcl-Class A, Xcl 266
- THE DOW CHEMICAL CO - Type Thermax Sheathing, Thermax Light Duty Insulation, Thermax Heavy Duty Insulation, Thermax Metal Building Board, Thermax White Finish Insulation, Thermax c Exterior Insulation, Thermax 3H Insulation, Thermax Plus Lister Panel, Thermax Heavy Duty Plus (HDP) and TUFF-R™ c Insulation

* Indicates such products shall bear the UL or cUL Certification Mark for jurisdictions employing the UL or cUL Certification (such as Canada), respectively.

Last Updated on 2014-12-03

Questions? Print this page Terms of Use Page Top

© 2015 UL LLC

When the UL Leaf Mark is on the product, or when the word "Environment" is included in the UL Mark, please search the UL Environment database for additional information regarding this product's certification.

The appearance of a company's name or product in this database does not in itself assure that products so identified have been manufactured under UL's Follow-Up Service. Only those products bearing the UL Mark should be considered to be Certified and covered under UL's Follow-Up Service. Always look for the Mark on the product.

UL permits the reproduction of the material contained in the Online Certification Directory subject to the following conditions: 1. The Guide Information, Assemblies, Constructions, Designs, Systems, and/or Certifications (files) must be presented in their entirety and in a non-misleading manner, without any manipulation of the data (or drawings). 2. The statement "Reprinted from the Online Certifications Directory with permission from UL" must appear adjacent to the extracted material. In addition, the reprinted material must include a copyright notice in the following format: "© 2015 UL LLC".

http://database.ul.com/cgi-bin/XYV/template/LISEXT/1FRAME/showpage.html?name=... 01/27/2015

TBA STUDIO
ARCHITECTURE
103 Cypress Street
West Monroe, LA 71291
Tel. 318.340.1550
Fax. 318.998.1315
www.tbastudio.com

TBA

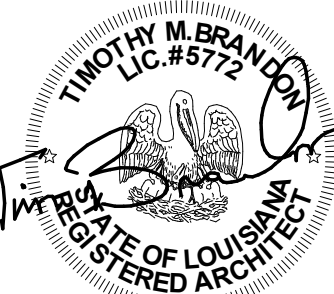

SCHOOL OF CONSTRUCTION PRACTICE
LAB BUILDING, UNIVERSITY OF
LOUISIANA MONROE

507 Filhiol Ave, Monroe, LA 71203

DRAWING REVISIONS

No.	Description	Date

DRAWN BY: KB, MU

CHECKED BY: CW

SHEET

LS1.02

Date: NOV 2025

Project No.: 24-0059

File Name:

DESCRIPTION:

PARTITION TYPES